



TECHNICAL INFORMATION

UPDATED November 2023

Address

Regent Theatre, 3 St. Helens Street, Ipswich, IP4 1HE
W3W – cracks.noon.shelf

Production Vehicle Entrance
Woodbridge Road, IP4 2EA
W3W – divide.rush.data

Capacity

9 Boxes (each box contains 4 seats)	36
Centre Stalls/Circle	1043
Back Stalls/Circle	253
Rear Side Stalls/Back Row Circle	113
Restricted View Stalls	84
Wheelchair Spaces	6
Total	<hr/> 1535

Contact

Technical Manager

Abbie Farnworth abbie.farnworth@ipswich.gov.uk 07385 936628

Programming, Ticketing & Settlements

Peter Ling peter.ling@ipswich.gov.uk

General Manager

Richie Ross Richie.ross@ipswich.gov.uk

Useful Measurements – DWG available on request

Stage Height

To Grid 12.6m / 41'4"

To Pros 7.2m / 23'7"

Pros → Grid 4.6m / 15'1"

Stage Depth

Back Wall → Pros 8.4m / 27'7"

Back Wall → Pit edge 8.9m / 29'3"

Back Wall → Stage front 11.4m/37'5"

All Measured At Centre – Please Add 1m/3'3" SL & Lose 1.5m/4'11" SR Due To Angle Of Wall

Stage Width

Pros 11.7m / 38'5"

Overall 19.7m / 64'7"

Roller Shutter

3.51m (w) x 3.85m (h)

Auditorium

Stage (Front) → Stalls Rear 22.5m/73'9"

Stage (Front) → Circle Rear 32.5m/106'7"

Multi-run (from Stage Front) 30m / 100'

Mixer Position 3.5m / 11'5" (w) x 2.4m / 7'10" (d)

PA Flying Points

From Centre 7.6m / 25'

From Pros 6.3m / 20'8"

Drop (from Point *not* ceiling) 13m / 42'8"

Advance Truss Auditorium

Width 15.24m/ 50'

From Pros 6.5m / 21'4"

Max Height Bottom Chord 9.1m / 29'10"

Access

Parking

We have a secure production vehicle area (PVA) which can accommodate up to 4 x 45' Trucks & 2 x Busses.

You will be provided with an access code by the Venue Stage Manager whilst advancing the show.

The PVA can be accessed via the gates located on Woodbridge Road, IP4 2EA at the rear of the venue.

Early arrival & prolonged stays can sometimes be accommodated dependant on other requirements of the PVA. Please confirm with the Stage Manager.

Shore power is available comprising of 4 x 16a 1Ø, 1 x 32a 1Ø & 3 x 32a 3Ø.

Load In

The load in is from the PVA level down to stage level via an S ramp, through a roller shutter 3.51m (w) x 3.85m (h) directly onto stage.

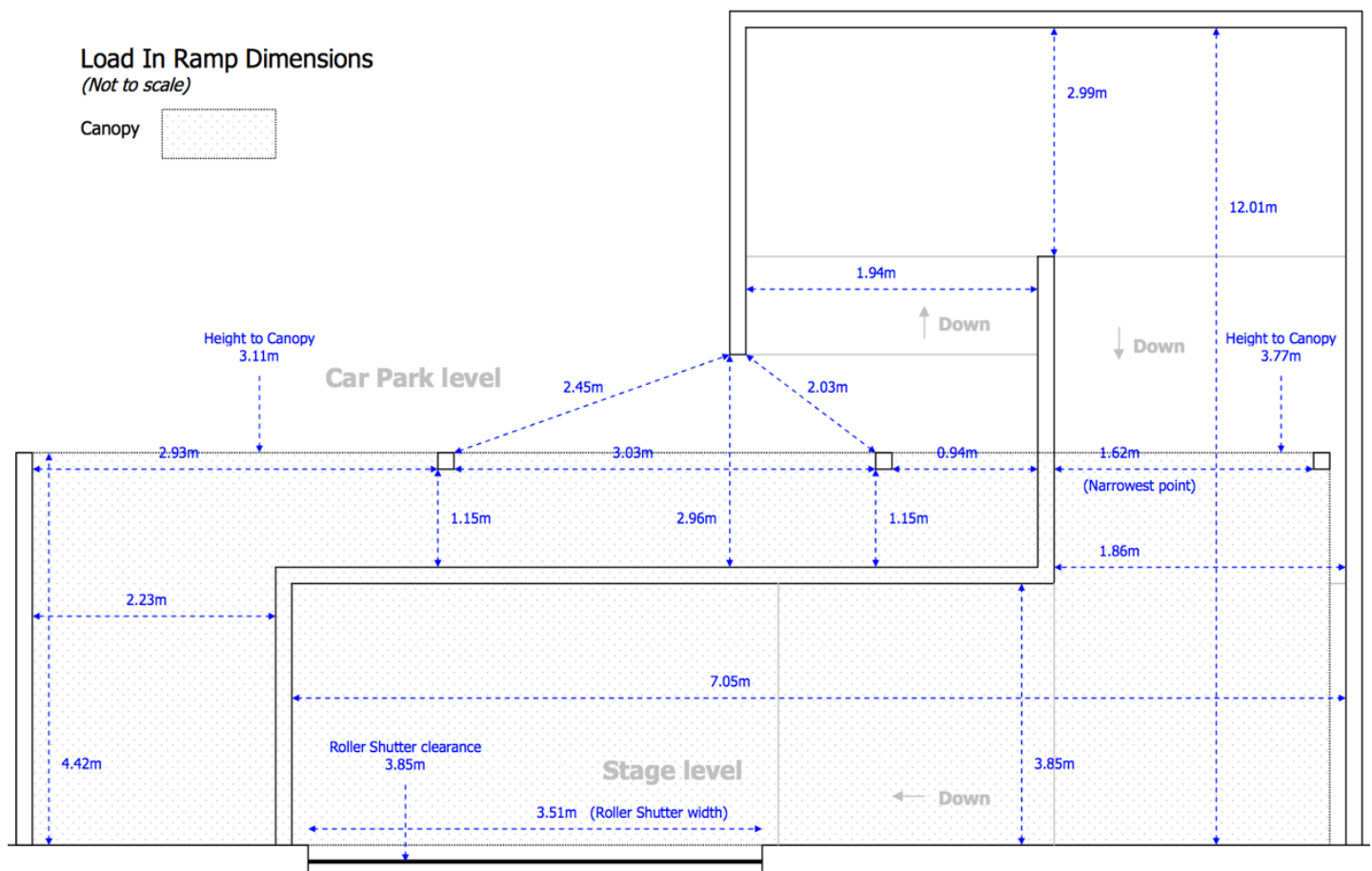

Power

Stage Left (Sound Power)

1 x 125a 3ø
1 x 63a 3ø
1 x 63a 1ø
1 x 32a 1ø
12 x 13a

Stage Right

300a 3ø Power Locks
1 x 32a 3ø
12 x 13a

Upstage

300a 3ø Power Locks
2 x 125a 3ø
2 x 63a 3ø
1 x 63a 1ø
2 x 32a 3ø
5 x 32a 1ø
12 x 16a 1ø
4 x 13a

Spot Position

4 x 16A 1 ø (Projection Rooms)
2 x 15A (Circle front)

The Cottage (Catering / Wardrobe)

1 x 32A 3ø
1 x 32A 1ø
14 x 13A Mains

Dimmable – 156 ways

24 x 15A – Flown: FoH Truss
72 x 15A – Flown: 4 x LX Bars
12x15A – SR Wing / 12x15A – SL Wing
12 x 15A – SL Pros Boom / 12x15A – SR Pros Boom
6 x 15A – SL Circle Boom / 6 x 15A – SR Circle Boom

Flying

3 x US 1 Tonne Motors
 3 x DS 1 Tonne Motors
 2 Tonne SWL Advance Truss
 12 x 80kg SWL Hemp Fly Bars
 3 x 130kg SWL Counterweight sets (Midstage)
 1 x 200kg SWL Fly Bar (Winch Operated)
 4 x 200kg SWL LX Bars (Winch Operated)

Hanging Plot

Bar #	SWL (kg)	From Iron Line
1	80	560mm / 1'10"
LX1 Winch	200	930mm / 3'6"
D/S Motors	3 x 1000	1200mm / 3'11"
2	80	1360mm / 4'6"
3	80	1550mm / 5'1"
Black Tab Winch	Fixed will not move	1730mm / 5'8"
4	80	2290mm / 7'6"
LX2 Winch	200	2610mm / 8'7"
5	80	2800mm / 9'2"
6 C/W	130	2980mm / 9'9"
7 C/W	130	3260mm / 10'8"
8 C/W	130	3520mm / 11'6"
LX3 Winch	200	3820mm / 12'6"
9	80	4150mm / 13'7"
10	80	4380mm / 14'4"
11	80	4580mm / 15'3"
LX4 Winch	200	5170mm / 16'11"
12	80	5370mm / 17'7"
13	80	5570mm / 18'3"
14	80	5860mm / 19'3"
U/S Motors	3 x 1000	6200mm / 20'4"
15	80	
16 Winch	200	Parallel to back wall

House Rigging Positions

Reference Point:

Safety Curtain line, 3.27m from downstage edge

NOT TO SCALE

Key



Pre-rigged 1T motor hoist



1T SWL rigging point (PA)

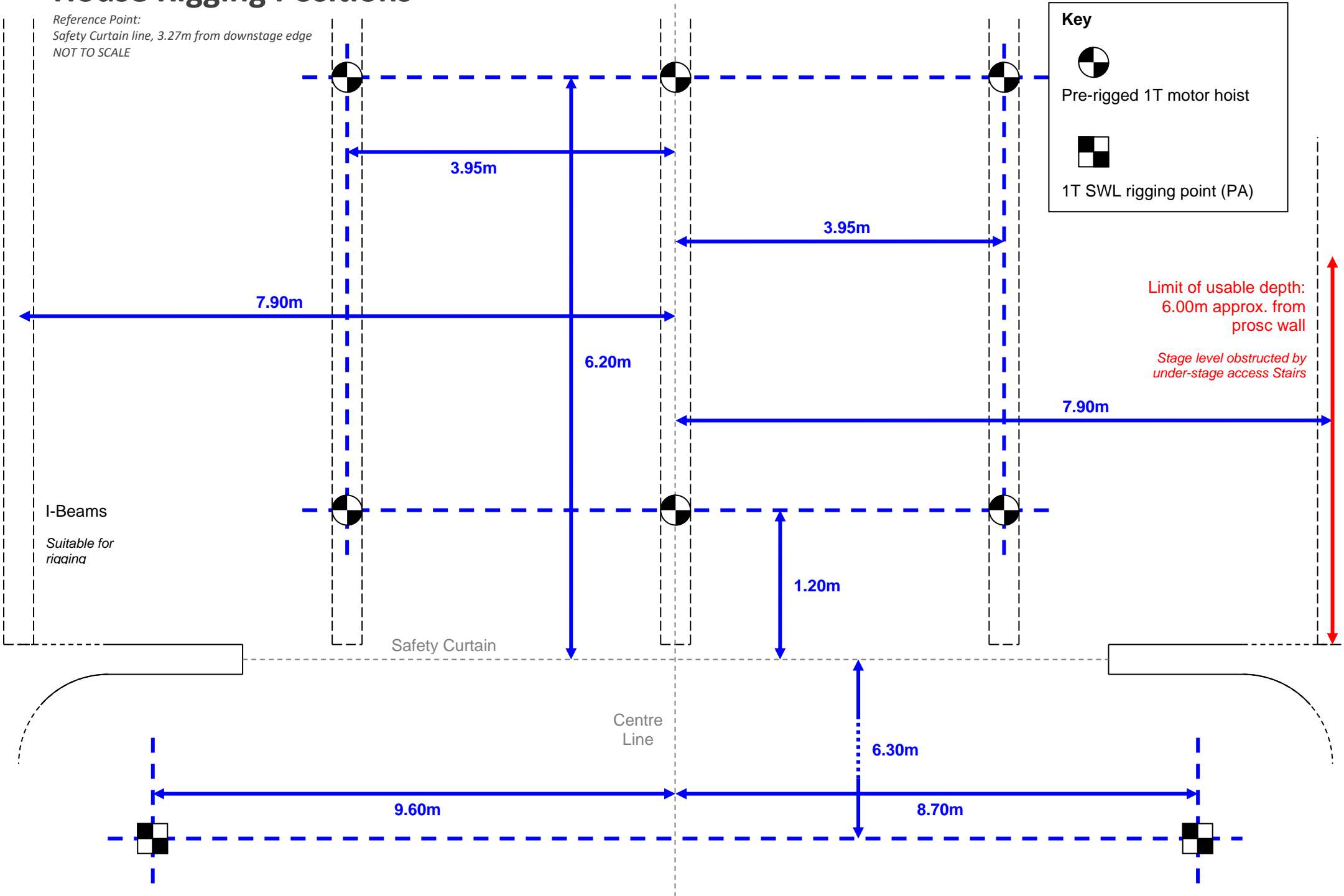

Signal Distribution

4 Universe DMX From DSL / DSR → LX Box (Patchable)
6 Cat5 From DSL / DSR → LX Box (Patchable)
24 Send / 8 Return XLR DSL → Mixer Position
Comms Points – DSL / DSR / Mixer Position / LX Box / Spot Box

Lighting

Avolites Quartz

24 x 6ch 2kw Zero88 Betapack3 dimmers
25 x Par 64 Parcan (CP60 and/or CP62)
2 x Par 64 Floorcan (CP60)
20 x Selecon “Rama” 1kW Fresnel
10 x Selecon “Arena” 2kW Fresnel
18 x ETC “Source 4 Zoom” 575W 15 – 30 Profile
3 x ETC “Source 4 Junior Zoom” 575W 25 – 50 Profile
7 x CCT “Starlette” 1kW Cyc-Flood
2 x Coemar “Infinity M” 700W Spot
4 x MAC 301 LED wash
2 x Robert Juliet “Korrigan” 1.2kW Followspot
1 x 6m x 6m White LED Starcloth Panel
1 x Unique Haze Machine

RBG House Lights Controlled Either Via CueServer Box At LX Position Or LX Desk

Sound

Available By Arrangement – Contact Stage Manager For Quotes

Access Equipment

1 x Tallescope 50518
1 x Snorkel UL40 Mast Lift

Stage Equipment

6 x 8x4 Lite Deck – Various Heights Available Upon Request
5 x Black Serge Borders
2 x Pair Black Serge Legs
1 x Full Black Serge
1 x Midstage Black Tab (Winch) Fixed position **not movable**
1 x Red House Tabs Fixed position **not movable**

Orchestra Pit

Available Upon Request.

Fire Curtain

Waiver In Place But Must Be Kept Clear.

Stage Crew

Experienced In-House Local Crew & Technicians Available On Request.

Rooms

8 x Dedicated Dressing Rooms Accessed Via USL ad New Building via the cottage entrance:

- Dressing Room 1 – Ground Floor – En-Suite – Capacity 1-4
- Dressing Room 2 – New building – 2 Showers – 2 Toilets – Capacity 10-12
- Dressing Room 3 – New building – 2 Showers – 2 Toilets – Capacity 6-8
- Dressing Room 4 Accessible – New building – 1 Showers – 1 Toilet – 1 Accessible Toilet/Shower – Capacity 6-8
- Dressing Room 5 – First Floor – Sink – Capacity 4-5
- Dressing Room 6 – First Floor – Sink – Capacity 4-5
- Shower – First Floor
- Dressing Room 7 – Second Floor – Sink – Capacity 4-5
- Dressing Room 8 – Second Floor – Sink – Capacity 4-5
- Toilet – Second Floor

The Cottage – Additional Building To Rear Of Building By Gate.

- Kitchen/ Multi Purpose Room – Ground Floor – Double Sink / Fridge
- Production Office – Ground Floor – Capacity 6-8
- Dressing Room 6 – First Floor – Capacity 6-8
- Dressing Room 7 – First Floor – Capacity 6-8
- Toilet – First Floor
- Double Shower Room – First Floor

New Building – Additional Building Accessible via the cottage or stage door

- Multi Space with kitchen – large area used for catering/ wardrobe.
sink / fridge freezer / washing machine / tumble dryer

WI-FI

Available Throughout Venue ***Touring password ArtsPower***

Towels

Venue Able To Provide Up To 100 On Request.

Ice

Venue Able To Provide On Request.

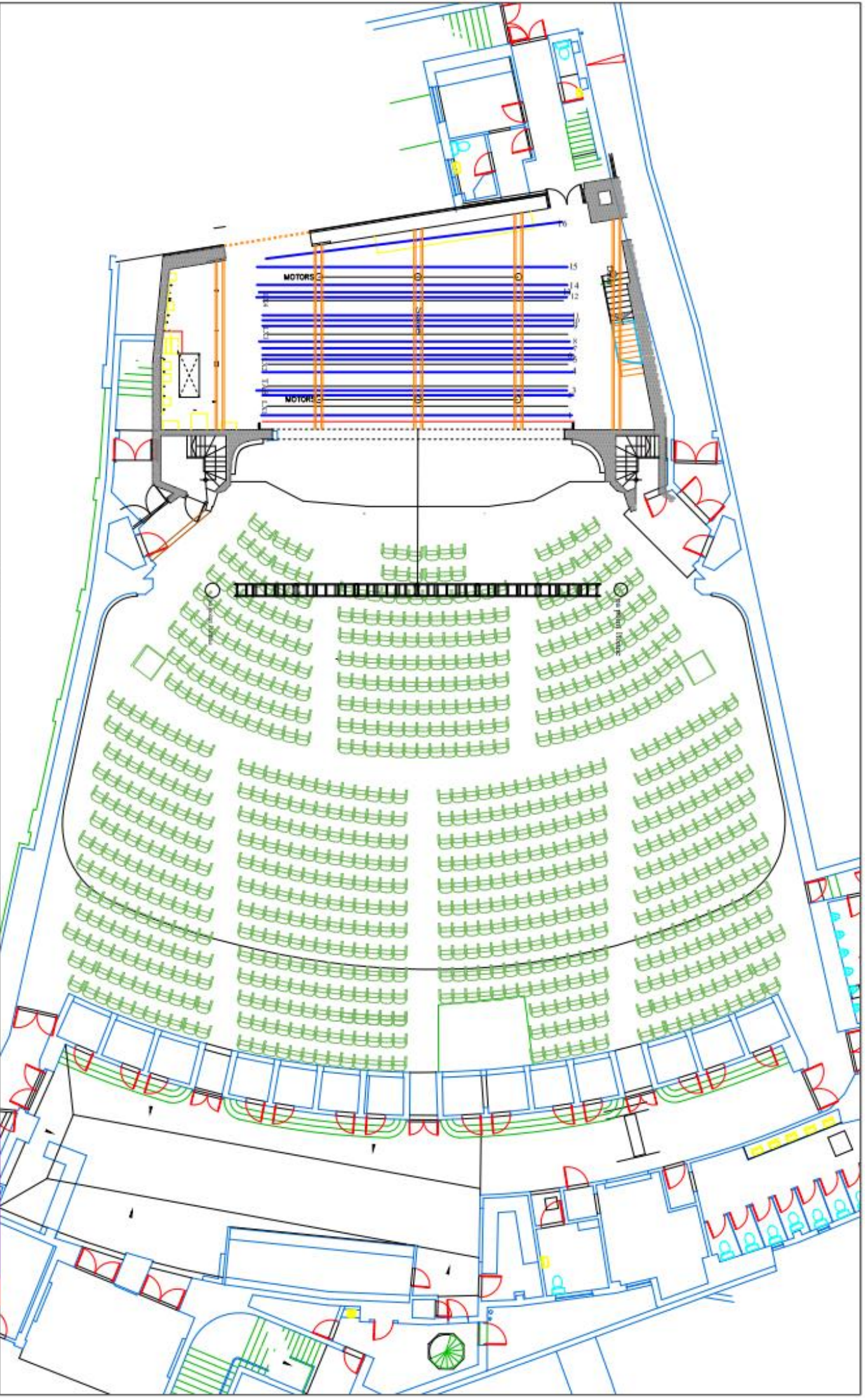

Client:

GROUNDPLAN

Venue:

IPSWICH_REGENT

Job Number:

NA

Drawn:

AF

Date:

15-08-22

Event Date:

NA

SCALE:

NTS

REVISION:

1



Auditorium Schematic

Section View

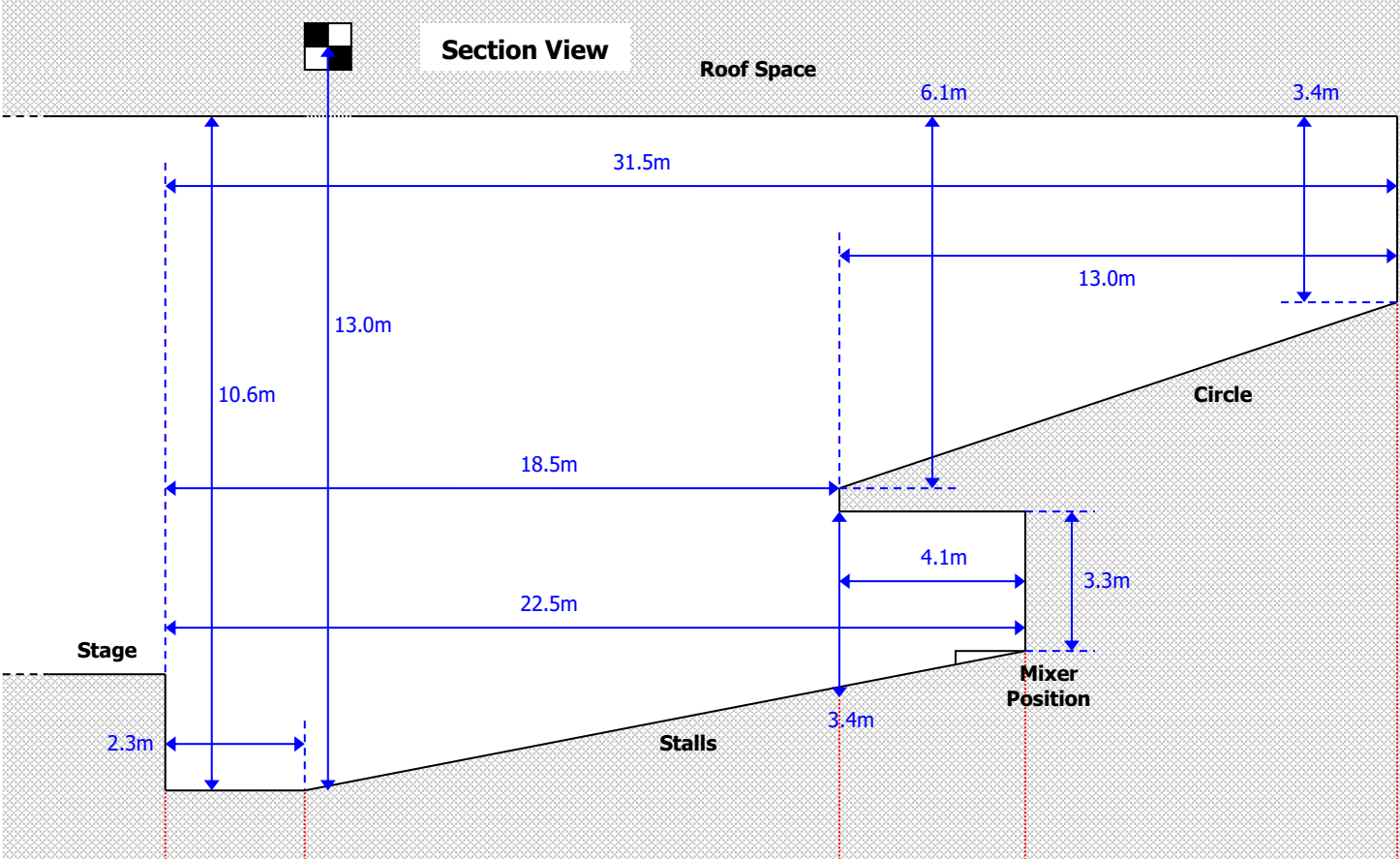

Plan View

